

SHOPPES AT SUMMIT – FOOD LION OUT PARCEL

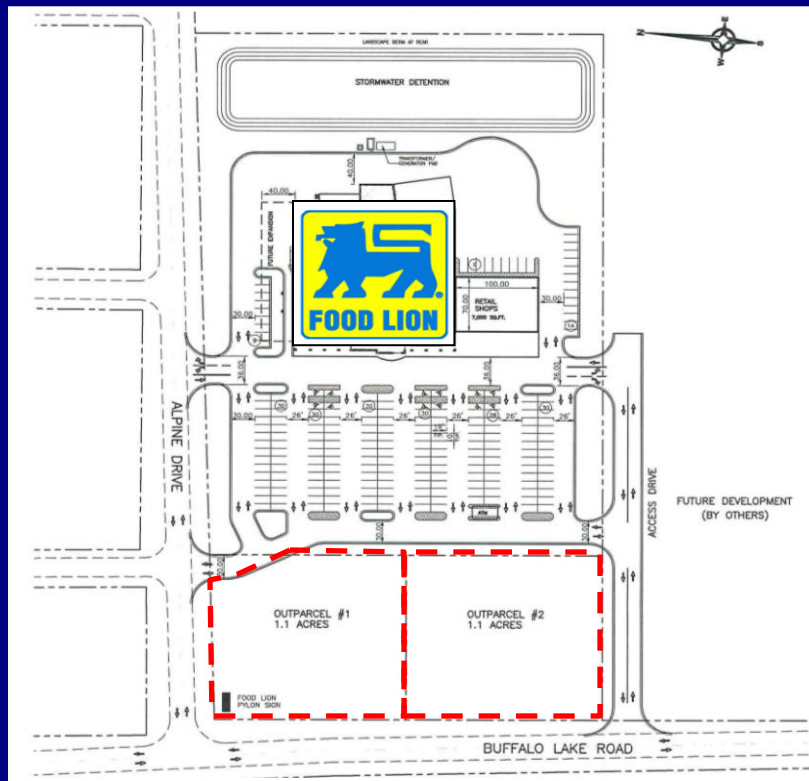

LOCATED AT THE INTERSECTION OF BUFFALO LAKES AND ALPINE DRIVE IN SPOUT SPRINGS, NC

- Shoppes at Summit is a new 41,928 square foot neighborhood center anchored by Food Lion.
- Construction commencing in the summer of 2010, with opening scheduled for 1st quarter of 2011.
- Two (2) one-acre (1+/-) out parcels available in front of the Food Lion Development.
- Outparcels are zoned commercial and public utilities are available.
- Sites are suitable for fast food, convenience store, branch bank, office, or other commercial use.

FEATURES



Venture Properties

PO Box 843 ~ Wilkesboro, NC 28697 ~ (336) 667-8000 ~ Fax (336) 667-8001

Venture Properties

Ronnie Walsh ~ (336) 667-8000 ext.17~ www.VPDevelopment.com

SHOPPES AT SUMMIT – FOOD LION OUT PARCELS



Demographic Summary / Population (2010)			
Spout Springs, N.C.	Unincorporated		
Total Harnett County	113,225		
	1 Mile	3 Mile	5 Mile
POPULATION	3,037	11,628	23,705
Employees (16+) *	584	2,801	6,125
% Employed *	94.2	94.2	93.9
HOUSEHOLDS			
Total Households	991	3,946	8,247
Median Home Value*	\$109,703	\$110,485	\$101,403
Average HH Income	\$61,716	\$63,015	\$58,464

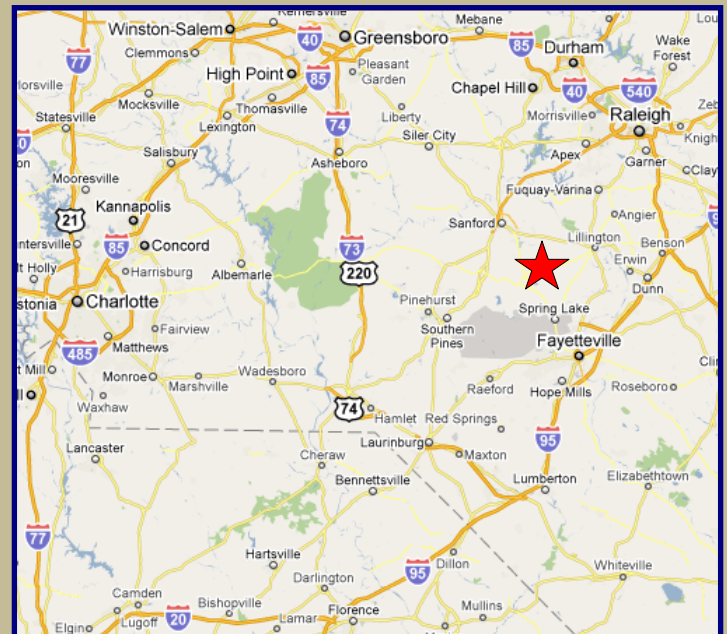

Venture Properties

PO Box 843 ~ Wilkesboro, NC 28697 ~ (336) 667-8000 ~ Fax (336)

Ronnie Walsh ~ (336) 667-8000 ext.17~ www.VPDevelopment.com